

1. KITCHEN CABINET PLAN  
SCALE: 3/8" = 1'-0"

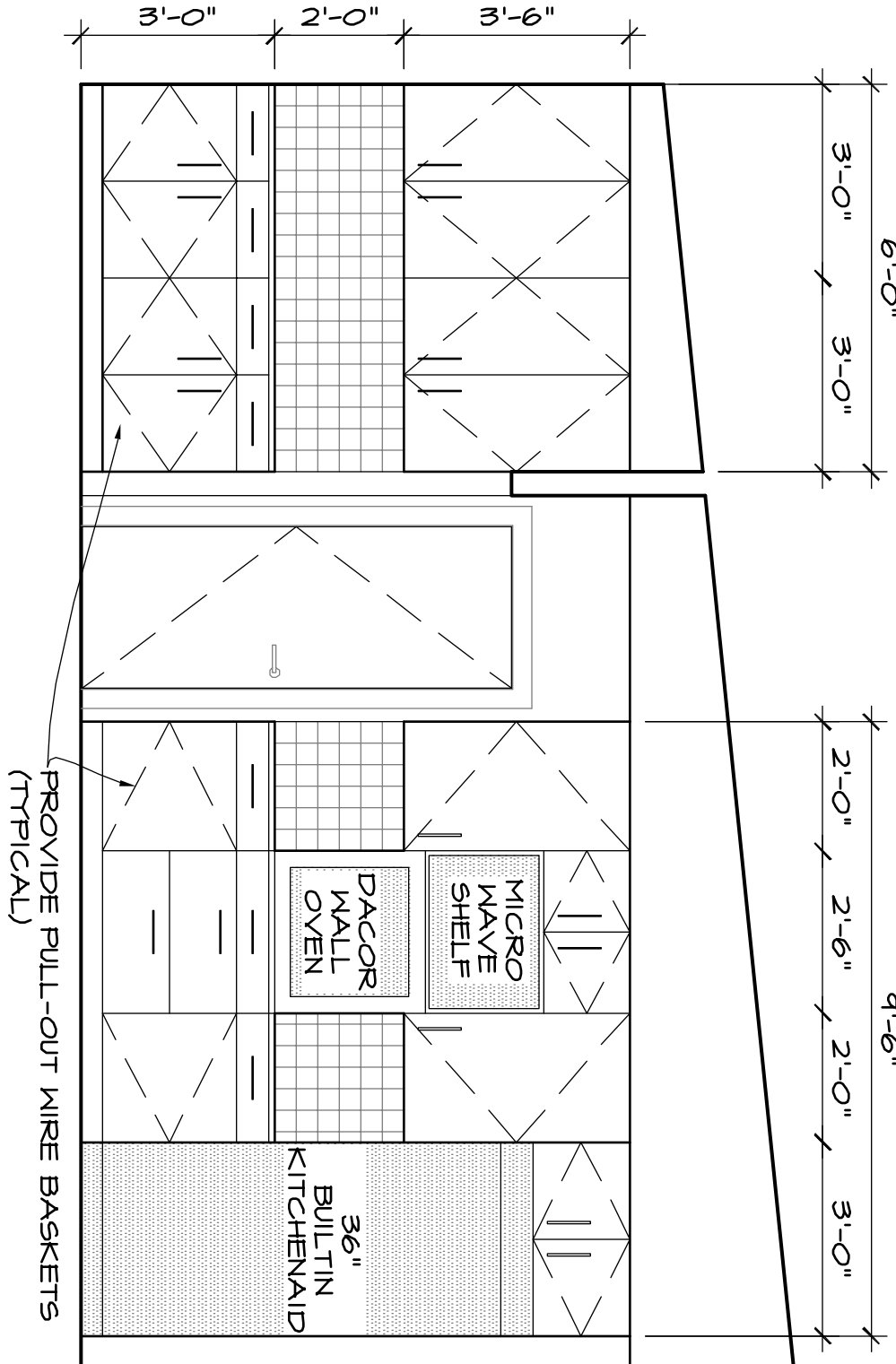

2. INTERIOR ELEVATION  
SCALE: 3/8" = 1'-0"

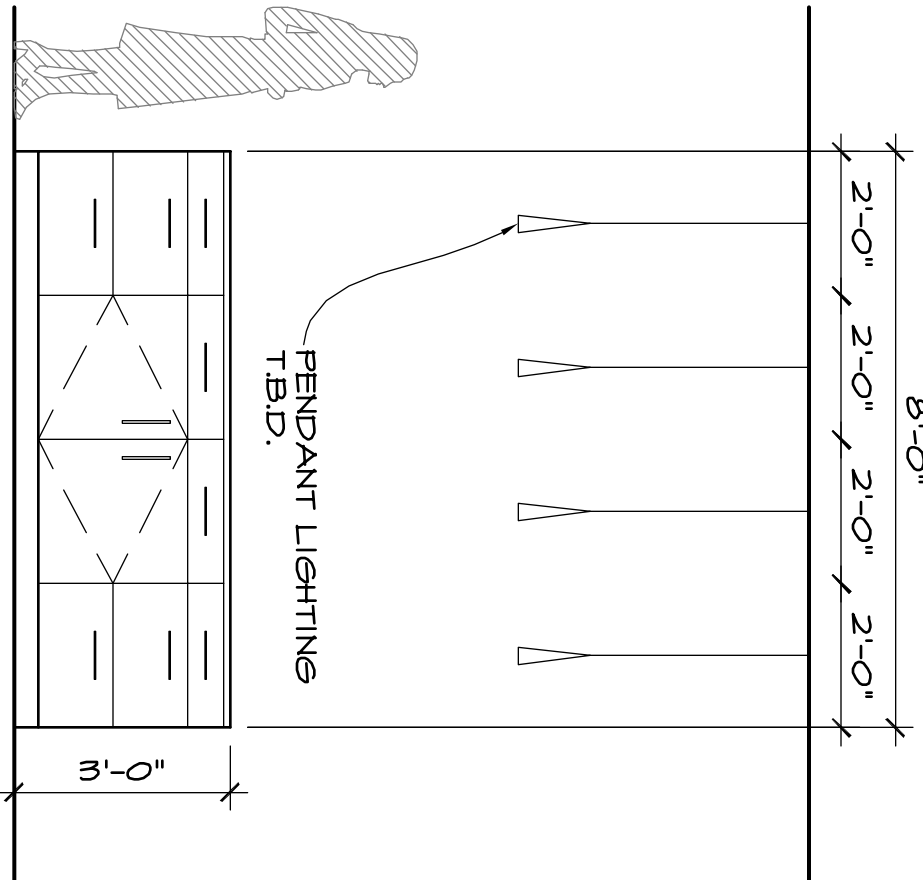

3. INTERIOR ELEVATION  
SCALE: 3/8" = 1'-0"

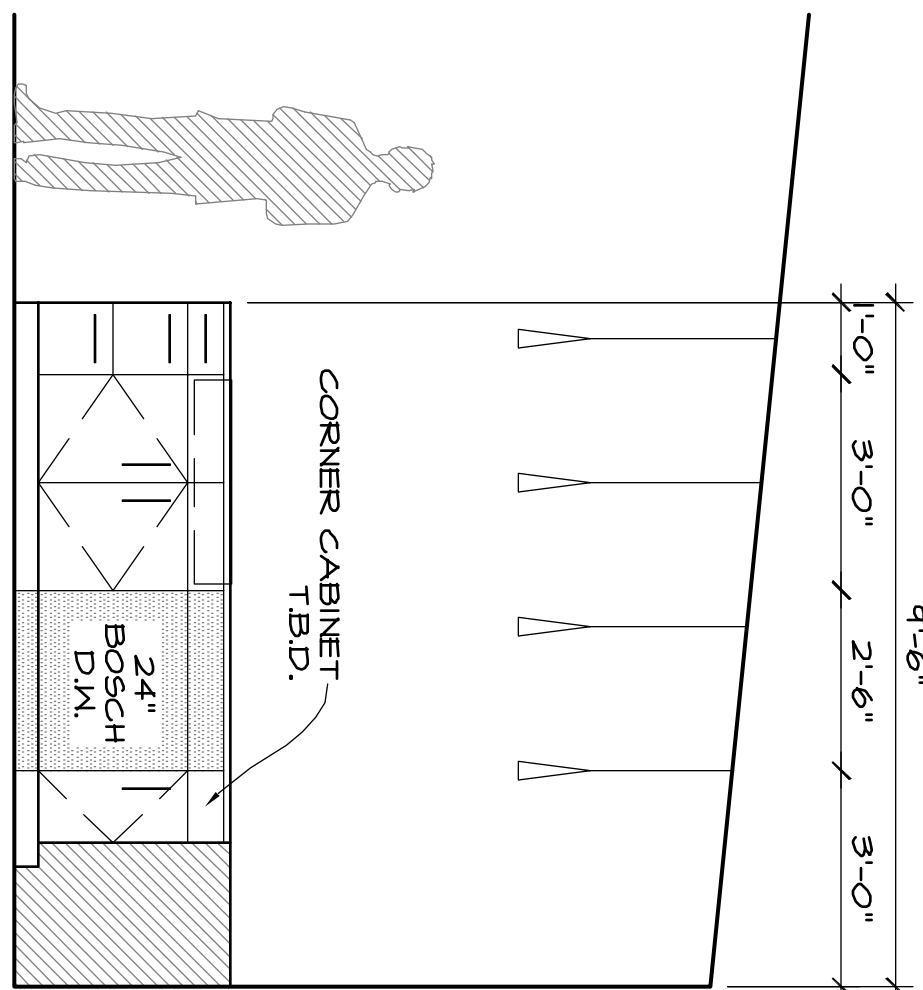

4. INTERIOR ELEVATION  
SCALE: 3/8" = 1'-0"

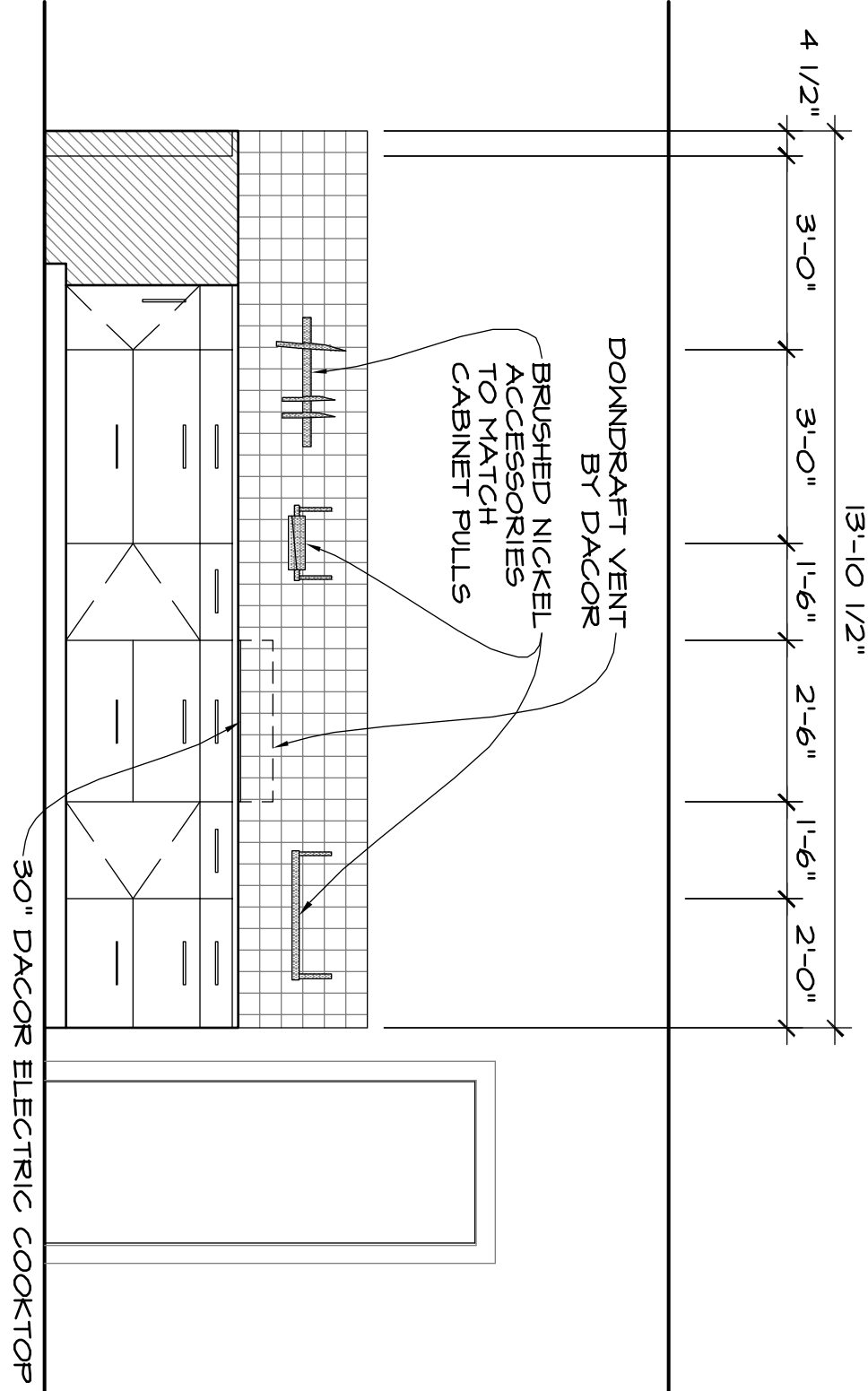

5. INTERIOR ELEVATION  
SCALE: 3/8" = 1'-0"

## DOOR SCHEDULE

#	SIZE	QTY	TYPE	GLAZING	HARDWARE	NOTES
01	3'-0"x7'-0"	3	PATIO	FULL	ENTRY	ANDERSON 400 SERIES
02	6'-0"x7'-0"	2	O.H.	NONE	-	INDUSTRIAL STEEL GARAGE DOOR
03	6'-0"x7'-0"	7	SLIDING	FULL	ENTRY	ANDERSON 400 SERIES
04	2'-6"x6'-8"	8	WOOD	NONE	VARIABLES	CLEAR FINISHED
05	2'-0"x6'-8"	4	WOOD	NONE	PASSAGE	CLEAR FINISHED
06	3'-0"x6'-8"	1	WOOD	NONE	PRIVACY	CLEAR FINISHED

\*NOTE: ALL HARDWARE TO BE BRUSHED NICKEL FINISH, KNOBS TO BE LEVER TYPE.  
INTERIOR OF PATIO DOORS TO BE PINE, EXTERIOR TO BE TERRATONE.

## WINDOW SCHEDULE

#	SIZE	QTY	TYPE	HEADER	NOTES
A	3'-0"x2'-0"	8	AMINING	7'-0"	ANDERSEN 400 SERIES
B	3'-0"x5'-0"	1	CASEMENT	7'-0"	ANDERSEN 400 SERIES
C	3'-0"x7'-0"	4	FIXED	7'-0"	ANDERSEN 400 SERIES
D	3'-0"x1'-6"	2	AMINING	7'-0"	ANDERSEN 400 SERIES
E	6'-0"x2'-6"	6	FIXED	9'-6"	ANDERSEN 400 SERIES
F	5'-4"x7'-0"	1	FIXED	7'-0"	FIELD FRAMED WINDOW IN SHOWER W/ 3-FORM GLAZING
G	2'-0"x7'-0"	2	FIXED	7'-0"	ANDERSEN 400 SERIES
H	2'-0"x2'-6"	2	FIXED	9'-6"	ANDERSEN 400 SERIES
I	3'-0"x2'-6"	4	FIXED	9'-6"	ANDERSEN 400 SERIES

\*NOTE: INTERIOR OF ANDERSEN WINDOWS TO BE PINE, EXTERIOR TO BE TERRATONE.  
ALL HARDWARE TO BE SATIN NICKEL FINISH.

COPYRIGHT © 2011  
RUSTY LONG ARCHITECT  
ALL RIGHTS RESERVED.  
THIS DRAWING IS THE PROPERTY  
OF RUSTY LONG ARCHITECT  
AND IS NOT TO BE REPRODUCED  
OR COPIED IN WHOLE OR IN  
PART WITHOUT WRITTEN  
PERMISSION FROM THE  
ARCHITECT.



## PRICING CONSTRUCTION SET

1544 DIRKSON COURT  
CARY, NC 27511  
919-602-4120

REVISIONS	ISSUED FOR REVIEW
6/1/2011	ISSUED FOR BIDS

DATE: August 1, 2011  
PROJECT #: 2011-JH-01  
DRAWN BY: RLT  
CHECKED BY: RLT

## ALLIGATOR MODERN DETAILS